



Graceful Life

2 BHK Lifestyle Homes @ Pimple Gurav



P52100002471

The project has been registered via MahaRERA registration number: P52100002471 and is available on the website <https://maharera.mahaonline.gov.in> under registered projects.



















## A Graceful Home In The True Sense Of The Term

Here is A unique Creation Which Envelopes You In Its Warmth, Caressees You With A Velvet Touch And Rejuvenates You From Within. Engracia Is A Home That Cherishes You And Strives To Make You More Energized Than Ever. Step Into This Extravagant Expanse And Start A Whole A new Enriching, Refreshing And Graceful Life.

  
**engracia**  
Graceful Life  
2 BHK Lifestyle Homes @ Pimple Gurav



# SPECIFICATION

 Amphi-Theatre	 Celebration Zone	 Three tier security	 Intercom
 Children's play area	 Temple	 Garbage Chute	 Pipe Gas
 Rain Water Harvesting	 Senior citizen plaza	 Sitting alcove	 Lawn Area
 Video door phone	 Club House	 Meditation Centre	 Water Body
 solar water heater system			

**Structure:**  
RCC Frame Earthquake Resistant Structure

**Plaster:**  
Inside: Plaster Gypsum  
Outside: Sand faced double coat cement plaster

**Tiles:**  
Vitrified tiles 800\*800 in all rooms

**Doors & Windows:**  
UPVC sliding window with mosquito net with granite sill  
Wooden door frames  
Designer Laminated main door  
M.S. railing

**Bathroom:**  
Concealed plumbing with Vitra/Jaguar or equivalent sanitary fitting  
C.P. fitting cold and hot mixing unit in Master toilet  
All toilet with lintel level dado of designer tiles  
Granite door frame

**Electrification:**  
TV & Telephone point  
Concealed wiring with standard switches fittings

**Kitchen:**  
Kitchen platform with granite top & Stainless sink

**Paint:**  
Internal wall with oil bound paint & External walls in Apex



ANNEXURE - A  
3rd,5th,7th FLOOR PLAN

SHOP/FLAT.NO.	FLAT CARPET	BALCONY CARPET	TERRACE CARPET
SHOP/FLAT.NO.	Sq.M	Sq.M	Sq.M
<b>C</b> TYPICAL EVEN FLOOR (3rd,5th & 7th)			
301,501,701	44.73	9.54	16.54
302,502,702	44.73	9.54	16.54
303,503,703	47.60	6.68	16.54
304,504,704	47.60	6.68	16.54
305,505,705	47.60	6.68	16.54
306,506,706	49.62	4.10	11.72
307,507,707	49.62	4.10	11.72

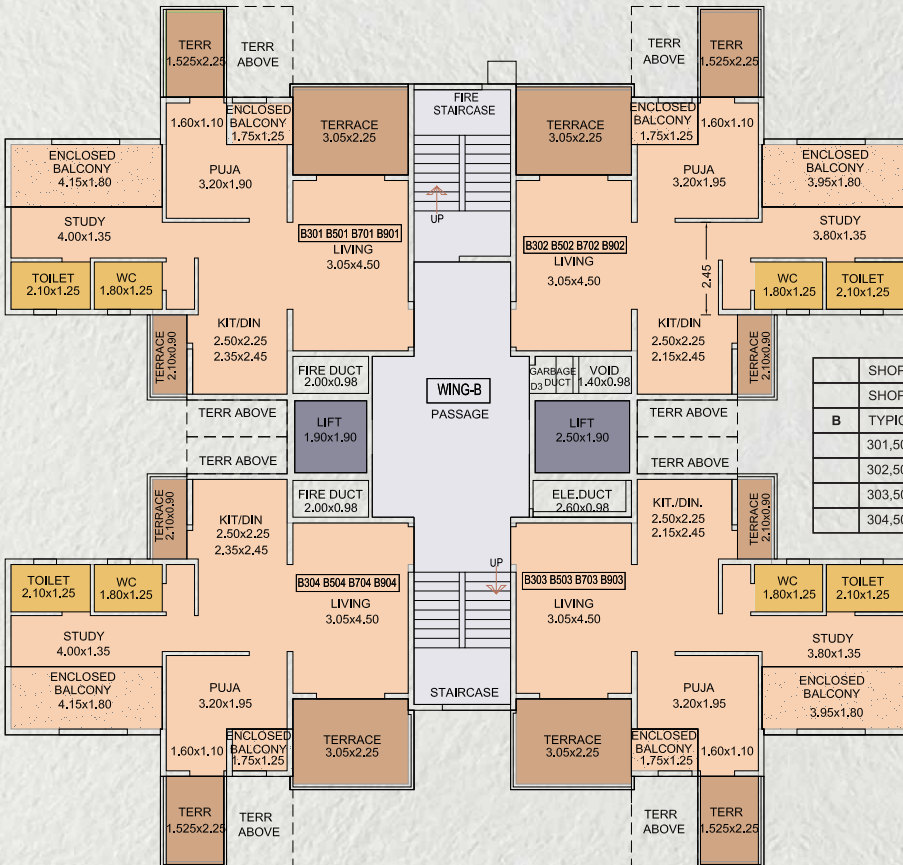

ANNEXURE - A  
TYPICAL - 3, 5, 7 & 9 FLOOR PLAN

SHOP/FLAT.NO.	FLAT CARPET	BALCONY CARPET	TERRACE CARPET
SHOP/FLAT.NO.	Sq.M	Sq.M	Sq.M
<b>B</b> TYPICAL EVEN FLOOR (3rd,5th 7th& 9th)			
301,501,701,901	48.02	8.38	11.89
302,502,702,902	47.49	8.05	11.89
303,503,703,903	47.49	8.05	11.89
304,504,704,904	48.02	8.38	11.89



**ANNEXURE - A**  
**2nd,4th,6th FLOOR PLAN**

SHOP/FLAT.NO.	FLAT CARPET	BALCONY CARPET	TERRACE CARPET
SHOP/FLAT.NO.	Sq.M	Sq.M	Sq.M
<b>C</b> TYPICAL EVEN FLOOR (2nd,4th & 6th)			
201,401,601	43.88	9.62	15.35
202,402,602	43.88	9.62	15.35
203,403,603	44.52	8.67	15.42
204,404,604	47.18	6.19	15.34
205,405,605	47.95	5.24	15.42
206,406,606	49.15	4.35	13.13
207,407,607	49.15	4.35	13.13

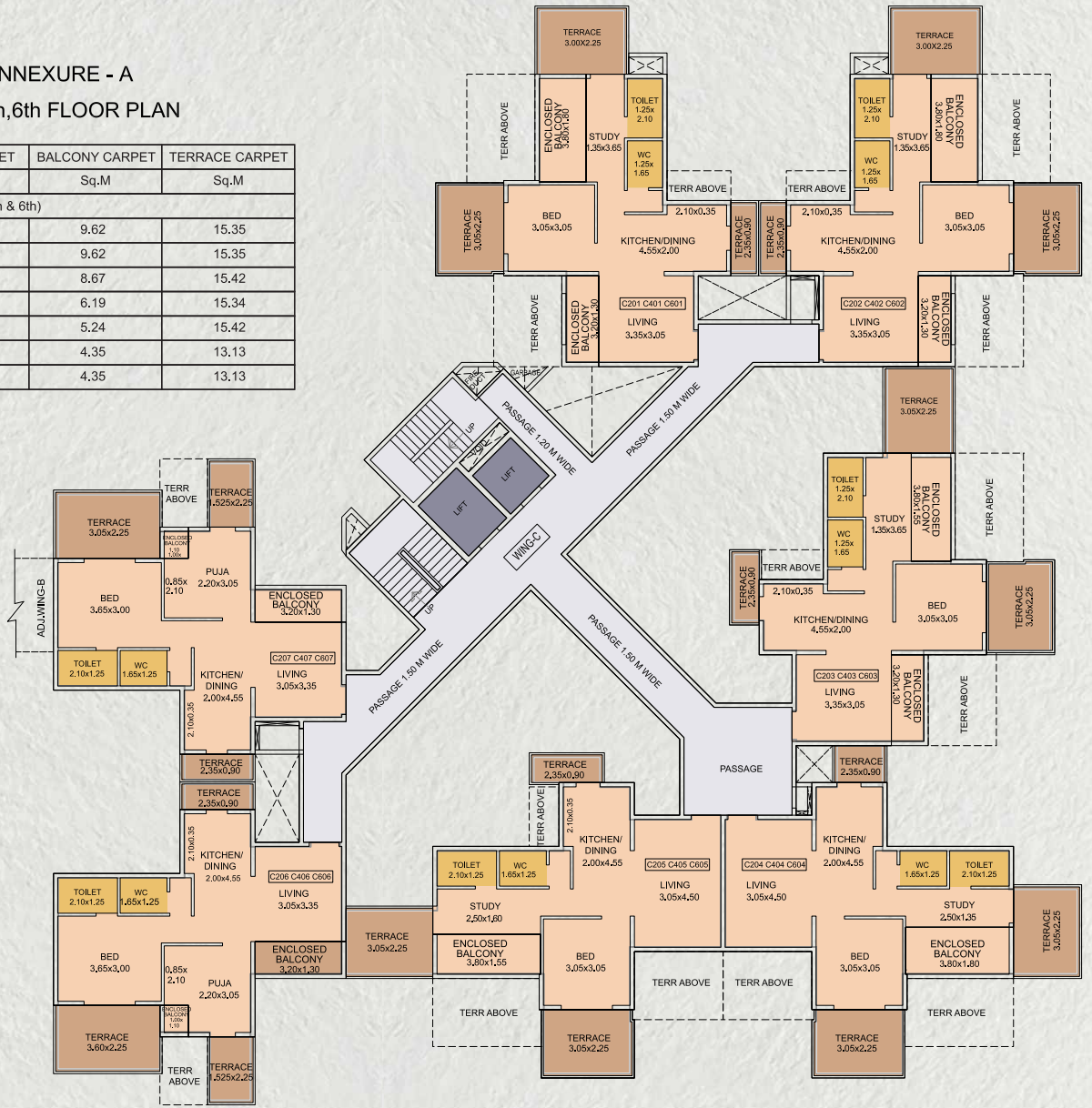

**ANNEXURE - A**  
**2nd,4th,6th FLOOR PLAN**

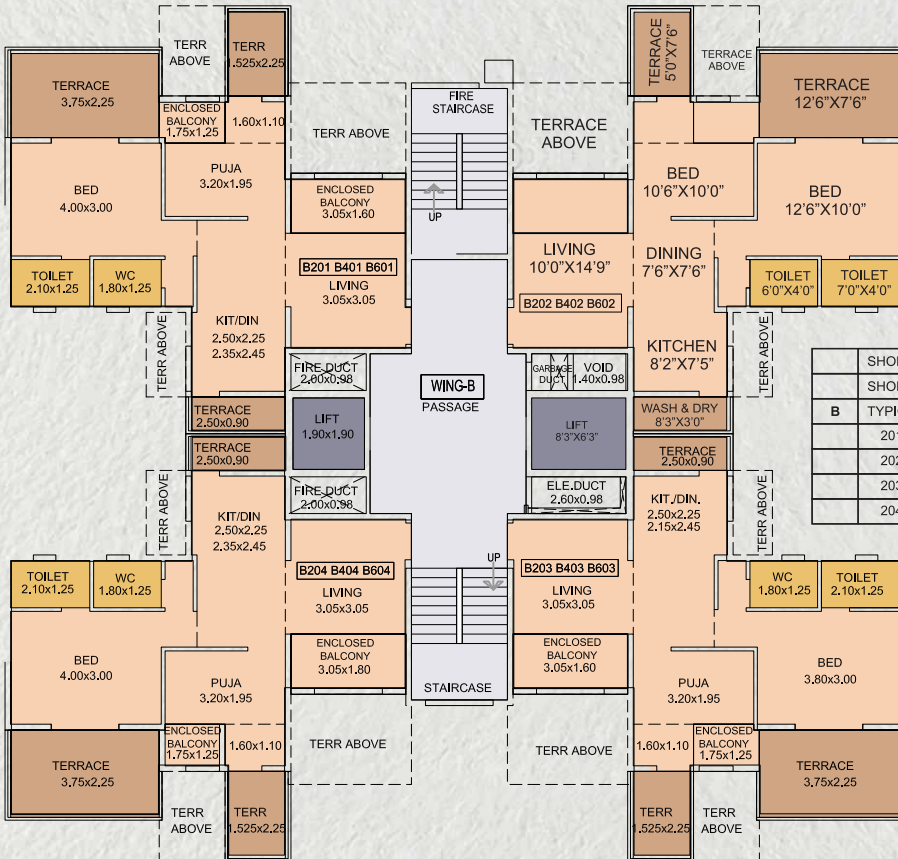

SHOP/FLAT.NO.	FLAT CARPET	BAL CARPET	TER CARPET
SHOP/FLAT.NO.	Sq.M	Sq.M	Sq.M
<b>B</b> TYPICAL EVEN FLOOR (2nd,4th & 6th)			
201,401,601	50.08	6.20	14.21
202,402,602	49.18	6.20	13.77
203,403,603	49.18	6.20	13.77
204,404,604	50.08	6.20	14.21

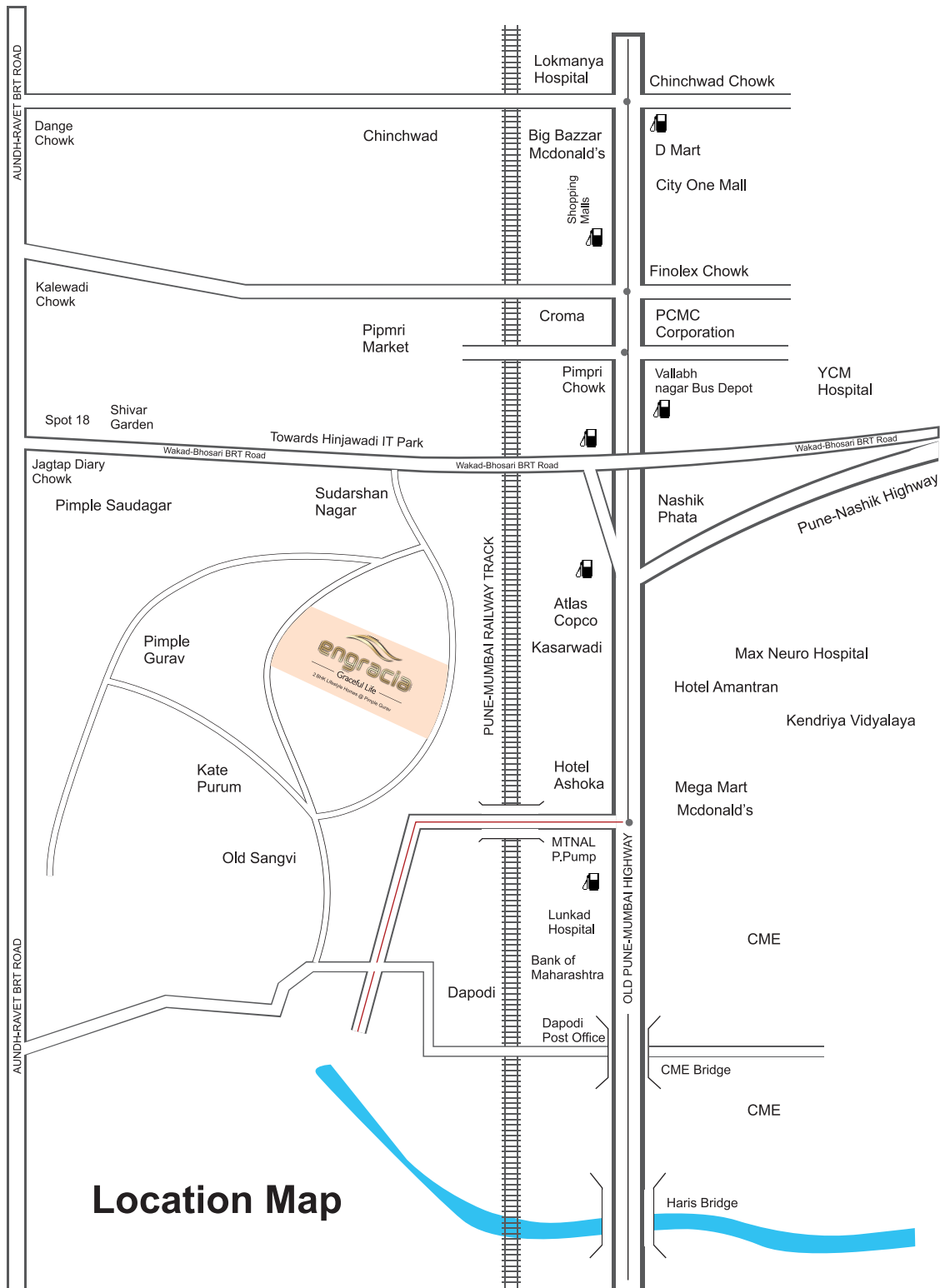

## Location Map

### CREDITS:

Architect:  
Solespace architectural consultants Pvt.Ltd

Rcc Designer:  
G.A. Bhilare & Associates

Legal Advisor:  
S.V.Kolse Patil

Landscape & PMC:  
Gensys Technologies Pvt.Ltd.



Site Address: Sarve No 24,60 ft Road, Near Mehfil Hotel  
Pimple Gurav, Pune 411061

Tel: +91 88888 33803 | 88888 33804

www.jagtappatil.com | sales@jagtappatil.com



Note: This brochure is purely conceptual and not a legal offering nor will be part of agreement. Nothing contained in this brochure will take precedence in the final agreement. Developers reserves all absolute rights to change, cancel, amend any plans, layout, amenities/specification/elevation without assigning any prior notice.